

### SINGLE ACTING FRONT END CYLINDER

HYD 135-5-2400 K

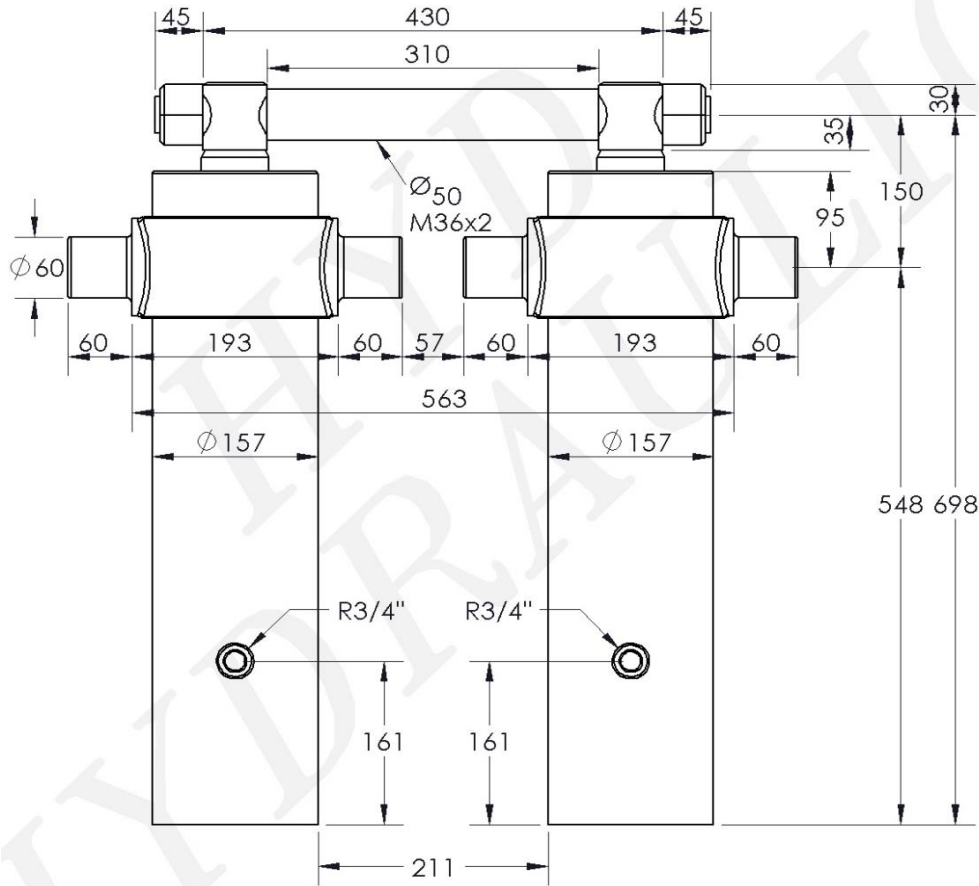

### TECHNICAL SPECIFICATIONS

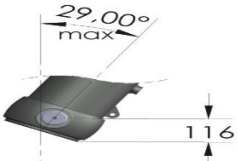

Working volume [lts]	22+22
Max.Working Pressure[bar]	250
Weight(cylinder)[kgs]	88+88
Min-Max.Cylinder Capacity[to]	36+36

Stage no	1	2	3	4	5	Total stroke
$\phi$ Stage [mm]	$\phi 135$	$\phi 116$	$\phi 98$	$\phi 80$	$\phi 63$	2400
Stroke [mm]	480	480	480	480	480	
Thrust at 250 Bar [Tons]	36	26	19	13	8	

This cylinder is used to lift up dampers that is loaded different materials, loads must be centered.

Cylinders should not be used as a main structural purposes be subject to side loads.

Cylinder should be mounted regarding to the instruction that are shown in technical design with working angle description.

Cylinder should not have more than 29 degree angles to return backside.

Cylinder is a cold drawn, seamless tubes which is ST52, E355, DIN2391 BK+S, E10305-2 standards.

Each stage tubes that is chrome coated with 20 micron, should be protected against the paints and chemicals.

Working temperature is between -40 C and 100 C

Painted by qualified acrylic materials.

Load capacity described by technical specifications.

Warranty is valid under the working principles and technical specification.

### HYD OTOMOTİV LTD.ŞTİ.

1. Organize Sanayi Bölgesi Budaközü Sokak 16/B ( KONYA) TURKEY

Tel +90 332 251 06 00-Fax +90 332 251 06 00

info@hydotomotiv.com.tr - www.hydotomotiv.com.tr